

# INSTALLATION INSTRUCTIONS – SLIDING OVERHEAD RACK

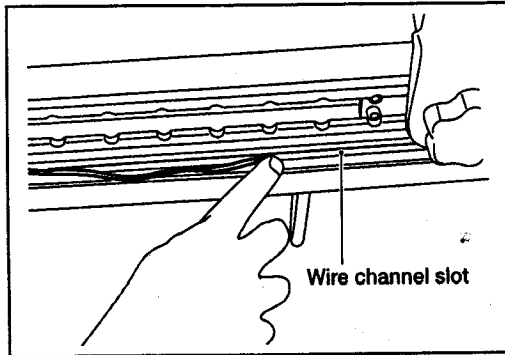

b) Insert the harness through the wire channel slot as shown.

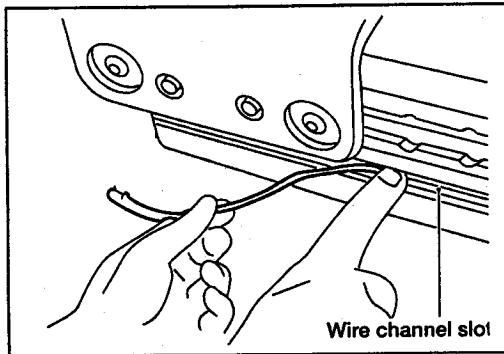

c) Continue to insert wire harness into wire channel slot completely to the forward end.

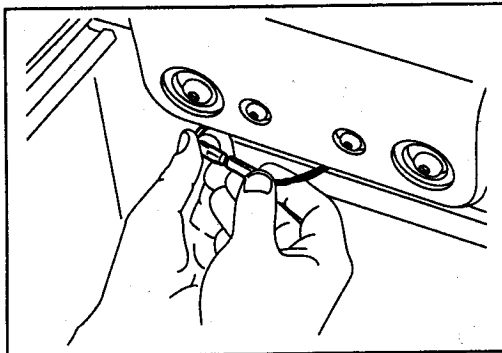

- d) Connect the harness just installed with the harness inside the wire channel.
- e) Push wire completely into channel.
- f) Install wire channel end cap.

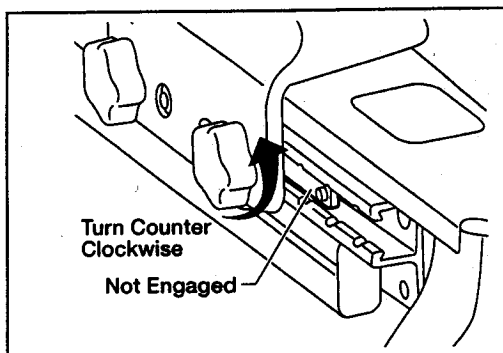

## 17) Adjusting the rear rack.

- a) If knobs are tight, turn knobs counter clockwise and loosen all knobs so that the lockplates are not engaged in the notches on the Utili-Track.
- b) Slide to the desired location making sure lockplates are lined up with the notches in the Utili-Track.
- c) Two people, one on each side, should slide the rack simultaneously and evenly to minimize binding.