



SERVICE BULLETIN

Classification: BT04-057	Reference: NTB05-004	Date: January 25, 2005
-----------------------------	-------------------------	---------------------------

REAR SLIDING WINDOW TRACK WATER LEAK

APPLIED VEHICLE: 2004-05 Titan (A60) – with manual rear sliding window

IF YOU CONFIRM:

Water is leaking from the Rear Sliding Window Track into the passenger compartment (see Figure 1).

ACTION:

- Add drain holes to the Rear Sliding Window Track (see Figure 1).
- Drill through the window track and glass sealant so the water can escape to the outside of the vehicle.
- Refer to the Service Procedure for details.

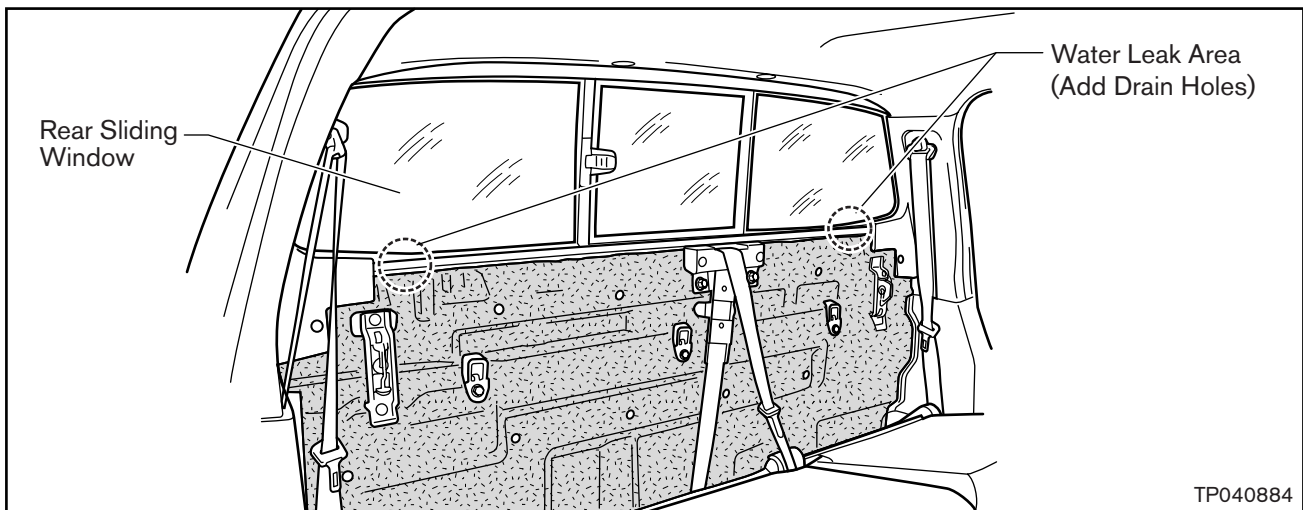

Figure 1

CLAIMS INFORMATION

Submit a Primary Operation (PO) line claim using the following claims coding:

DESCRIPTION	OP CODE	SYM	DIA	FRT
RPR Rear Sliding Window Track	BX35AA	ZQ	32	0.6 hrs

SERVICE PROCEDURE

CAUTION: Use suitable covers to protect upholstery, carpet, paint, trim, etc. when performing this procedure.

Add drain holes to the Rear Sliding Window Track as follows:

NOTE:

- The following shows you how to perform this procedure on one end of the Sliding Window Track.
- You'll be performing this procedure on both ends of the Sliding Window Track.
- The procedure involves drilling through the window track and glass sealant, **NOT through the vehicle body.**

1. Use a Plastic Pry Tool (such as essential Trim Tool Set J-46534 or equivalent) to remove two Plastic Clips from the Carpet Pad (see Figure 2).

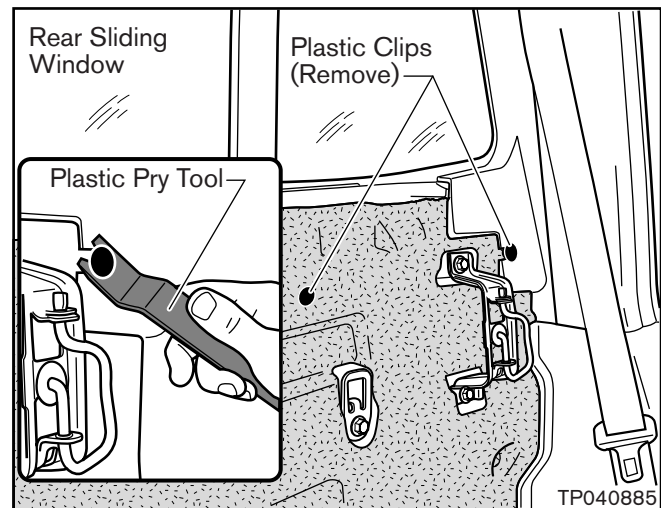

Figure 2

2. Fold down the Carpet Pad (see Figure 3).

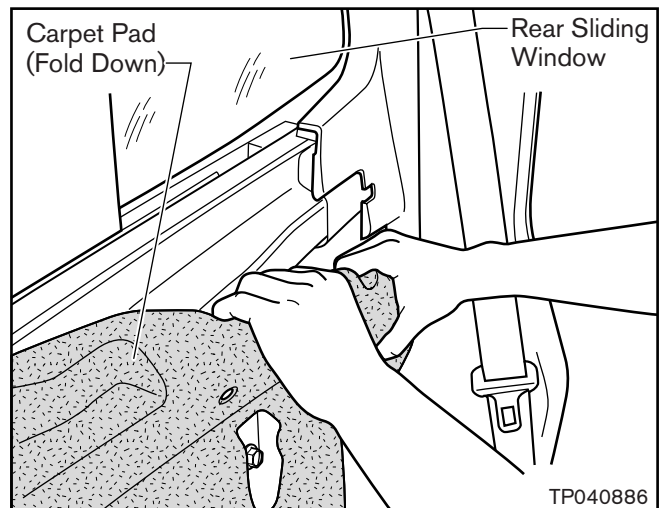

Figure 3

3. Use a 5-mm (13/64") drill bit to drill two holes in the bottom of the lower Sliding Window Track as follows:
 - a. Place a Cardboard Protector between the lower Sliding Window Track and the vehicle body sheet metal (pinch weld). See Figure 4.
 - b. Very carefully drill two 5-mm (13/64") holes in the bottom of the lower Sliding Window Track at the locations shown in Figure 4.

CAUTION: Do NOT drill into the body sheet metal with the drill bit (see Figure 4).

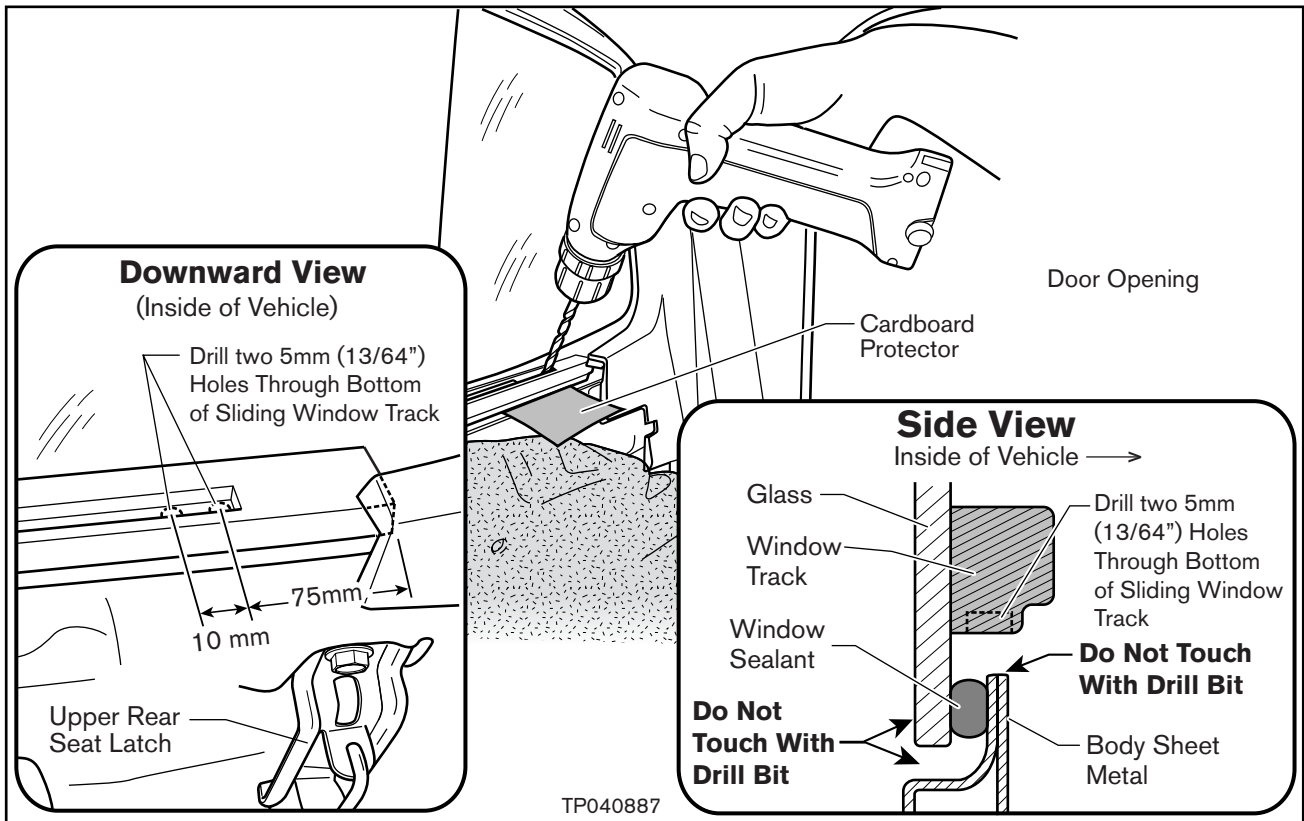

Figure 4

4. Use a vacuum to remove all metal and plastic shavings. Also, if needed, a magnet can be used to remove the metal shavings.

5. Drill two holes through the Sliding Window Sealant as follows:

- a. On the outside of the vehicle, apply 3 layers of the vinyl tape to the body sheet metal below the area that you'll be drilling (see Figure 5).
 - This will help prevent the brass tubing (drilling tool) from accidentally touching the body sheet metal/paint.

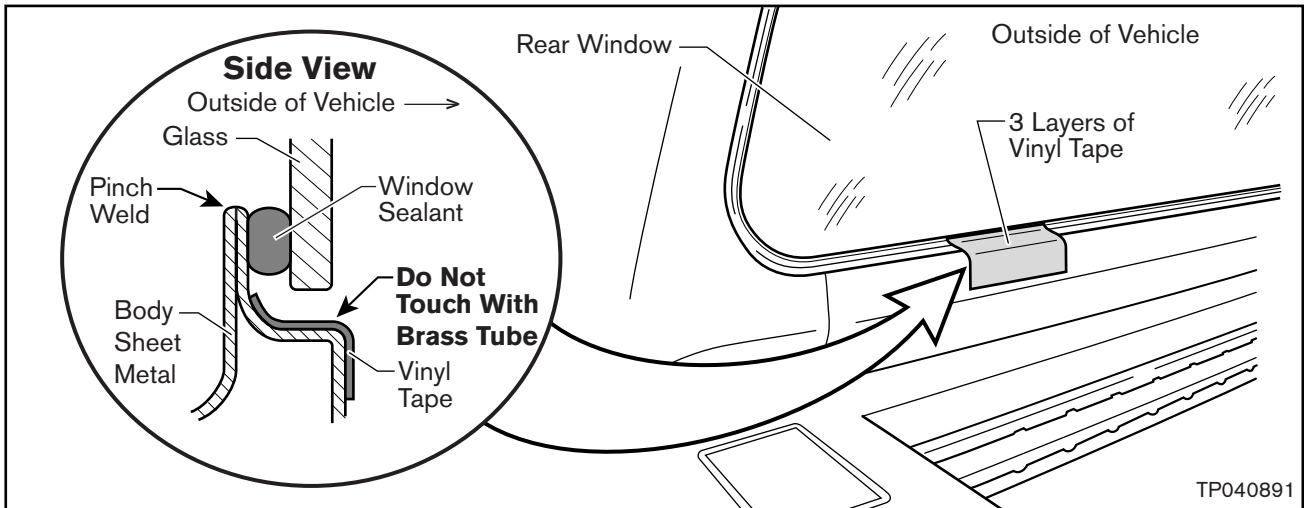

Figure 5

- b. On the inside of the vehicle, remove the Cardboard Protector and apply 3 layers of vinyl tape over the body sheet metal (pinch weld) below the 5-mm holes you just drilled (see Figure 6).
 - This will help prevent the brass tubing (drilling tool) from accidentally touching the body sheet metal/paint.

NOTE: For the next step (step C on the next page), you'll be drilling through the Sliding Window Sealant using a 6-inch piece of 5/32" diameter brass tube with 0.014" wall thickness.

- Obtain the brass tube from a local source or you can contact:

McMaster-Carr
www.mcmaster.com

- The part number for the McMaster-Carr 5/32" brass tube w/ 0.014" wall thickness is #8859k21.

- c. Using a piece of brass tube in a drill motor, and going through the 5-mm drilled holes, very carefully drill two holes through the Sliding Window Sealant (see Figure 6).

CAUTION: Do NOT touch the window glass or body sheet metal/paint with the brass tube.

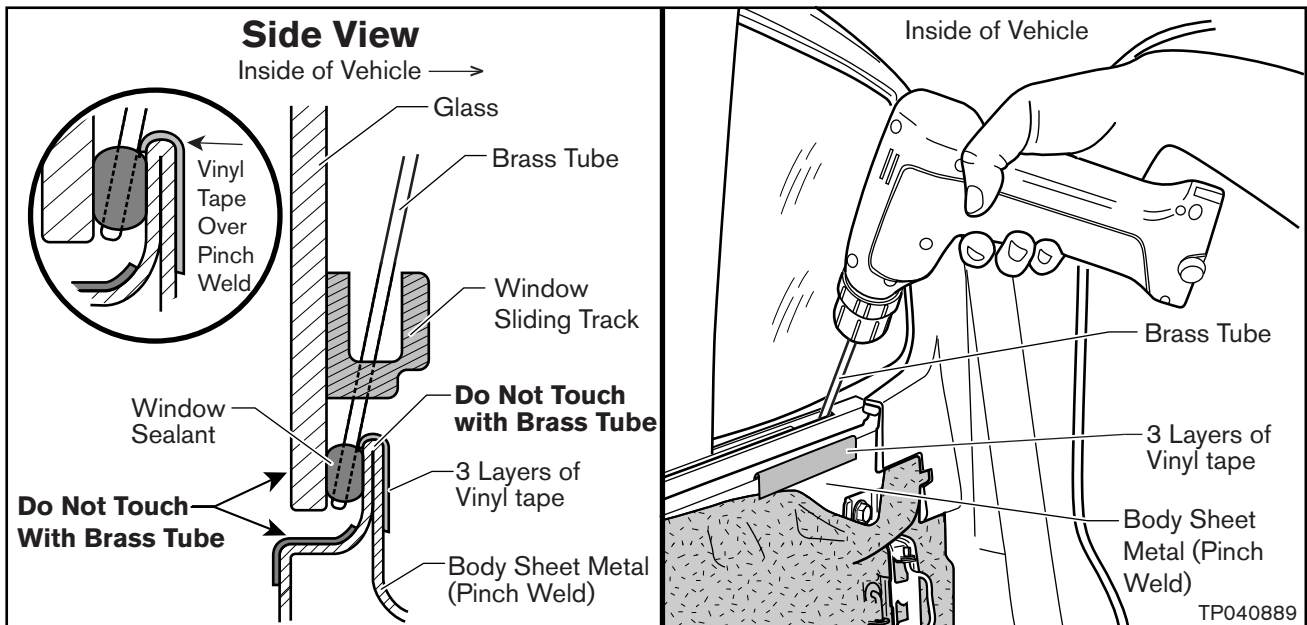

Figure 6

6. Use a small paint brush to apply Epoxy Primer to the 5-mm drilled holes in the bottom of the Sliding Track. Also, apply Primer to the Body Sheet Metal if you damaged the paint while drilling (remove vinyl tape first). See Figure 7.

- Use PPG **DP90LF & DP402LF**.
- Obtain primer from your local automotive paint supplier.
- Mix the primer according to the manufacturer's recommendation.
- Allow the primer to dry per the manufacturer's recommendation.

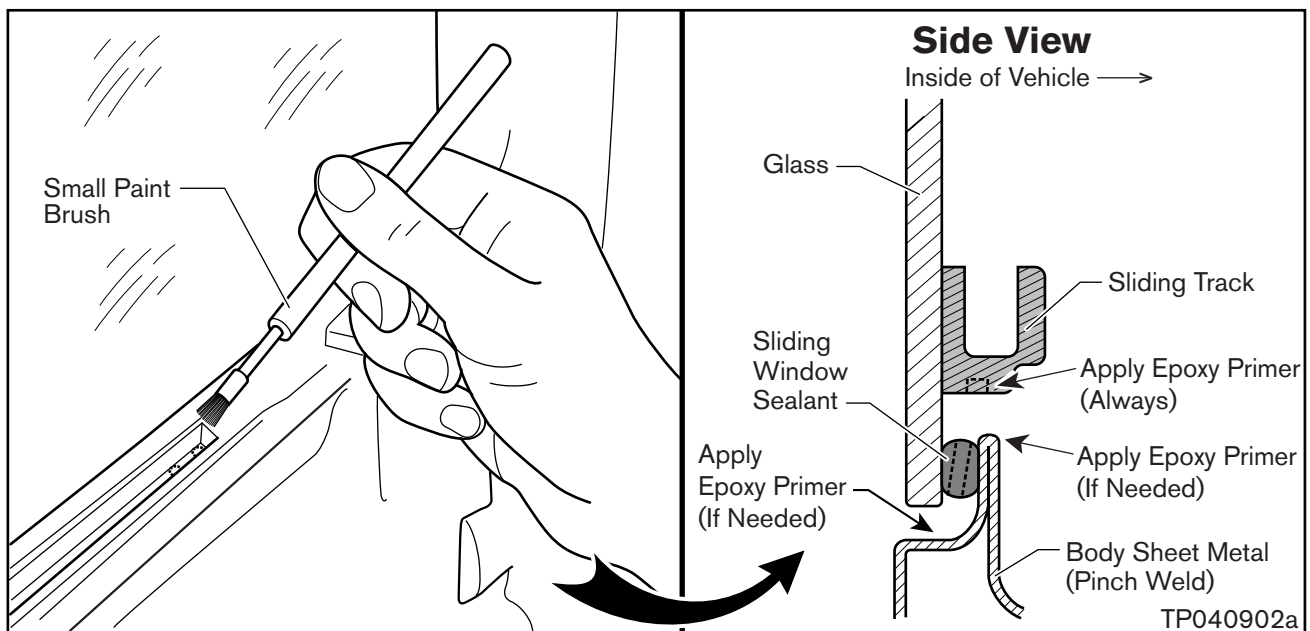

Figure 7

7. Seal the area around the drilled holes as follows:

a. First, apply a piece of Butyl Tape (at the drilled holes location) over the gap between the Sliding Track and the body sheet metal (pinch weld). See Figure 8.

- Butyl Tape Size: about 25mm (1 inch) wide and 38mm (1.5 inches) long.
- Obtain the Butyl Tape from a local source or you can contact:

McMaster-Carr
www.mcmaster.com

- The part number for the McMaster-Carr Butyl Tape is #76385A15.

b. Then, apply Black Silicone Sealant at each end of the Butyl Tape to fill up the area between the bottom of the Sliding Track and the top of the Window Sealant (see Figure 8).

NOTE: Be careful not to cover up the drilled holes with the Black Silicone Sealant.

- Obtain the Black Silicone Sealant from a local source or you can contact:

McMaster-Carr
www.mcmaster.com

- The part number for the McMaster-Carr Black Silicone Sealant is #66235A1 (i.e., Dow Corning 832 Multisurface Adhesive/Sealant).

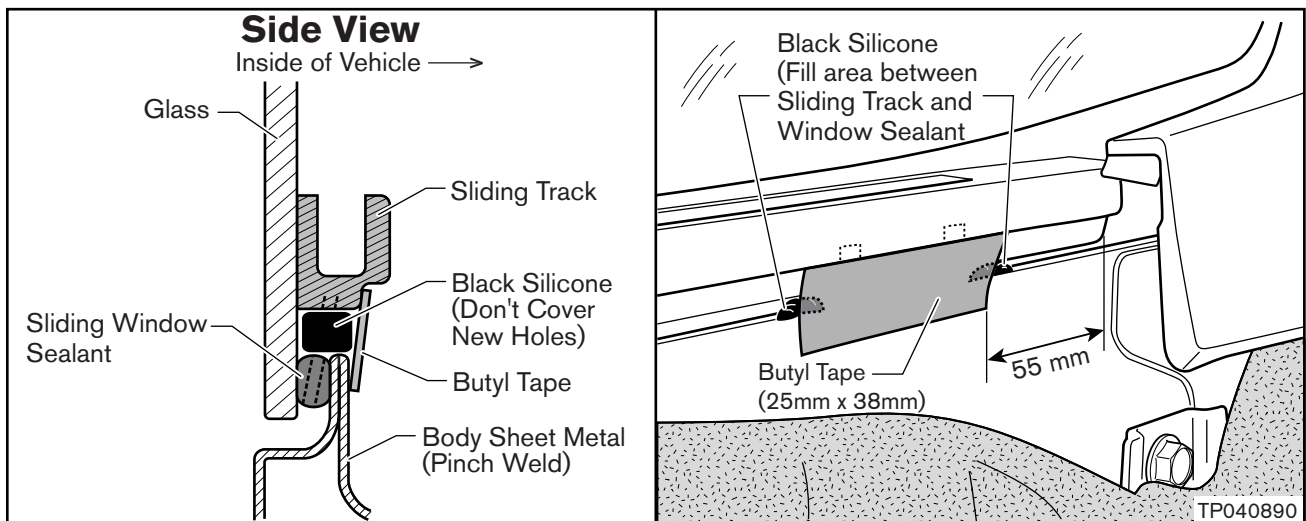

Figure 8

8. After you have finished with this end, perform the above steps on the other end of the Sliding Window Track.

9. Confirm the incident is resolved.

10. Remove all vinyl tape and re-assemble all previously removed/re-positioned components. Clean up as needed.